

NANOCAM+^{PLUS}®

USER MANUAL



Full HD Discreet Barrel Dash Camera
with LCD Screen, GPS and Wi-Fi



Your Safety. Our Priority.

NCP-DVR200

CONTENTS

1.0	BATTERY WARNING	6
2.0	INTRODUCTION	7
3.0	PACKAGE CONTENTS	8
4.0	SPECIFICATIONS	9
5.0	PRODUCT OVERVIEW	10
6.0	DISPLAY SCREEN INDICATORS	11
7.0	QUICK KEY FUNCTIONS	12
8.0	INSTALLATION INSTRUCTIONS	13
9.0	GETTING STARTED	15
10.0	MICRO SD CARD WARNING	17
10.1	Formatting a Micro SD Card	17
11.0	DOWNLOADING AND INSTALLING THE NCP-SYNC APP	18
12.0	NCP-SYNC APP OPERATION	20

12.1	Video playback	20
12.2	Video download	21
12.3	Video sharing on social media.....	21
13.0	NCP-SYNC APP SETTINGS	22
14.0	WARRANTY TERMS AND CONDITIONS.....	26

CAUTION

- Ensure that the dash camera is used in compliance with your country's road laws. Please make sure that you are familiar with your local road legislation before device use.
- Please set the time and date on the device before doing any recording.
- The notifications given by the dash camera are only suggestions. Please drive according to actual road conditions.
- This device is only for non-commercial use within the limits permitted by the relevant laws.
- Avoid using the dash camera in the vicinity of any device that emits radio interference (such as microwave ovens).
- It is considered as normal operation when the dash camera gets warmed during use.

1.0 BATTERY WARNING

- Always charge the dash camera using the supplied charger. Improper charging of the dash camera may result in internal battery failure.
- Never dismantle the dash camera or expose the internal battery.
- Do not dispose of the dash camera in fire.
- Please dispose of the dash camera in accordance with local regulations.
- Do not attempt to replace or expose the internal battery.

2.0 INTRODUCTION

Thank you for purchasing a Nanocam Plus Dash Camera. We are certain that our product will give you trouble-free operation while providing you with a safety feature that enhances your driving experience. Our products, like most after-market enhanced safety devices, are designed to assist and aid the driver, and not to replace the manual function of the person operating the vehicle. Please read through these instructions carefully before attempting to install and use this product.

For the latest manual and product updates, please visit our websites at:

www.nanocamplus.com.au or **www.nanocamplus.co.nz**

3.0 PACKAGE CONTENTS



Dash Camera x1



3M Adhesive Mount x1



12/24V Adaptor Charger x1



Electrostatic films x2



Cable clips x5



Pry tool x1



Quick Start Guide x1



User Manual x1

4.0 SPECIFICATIONS

Model	NCP-DVR200
Video resolution	1920 x 1080p @ 30FPS
Wi-Fi	Built-in
Battery	Built-in with supercapacitor
Power interface	5V 1A
Operation temperature	-20°C to 70°C
GPS	Built-In

5.0 PRODUCT OVERVIEW

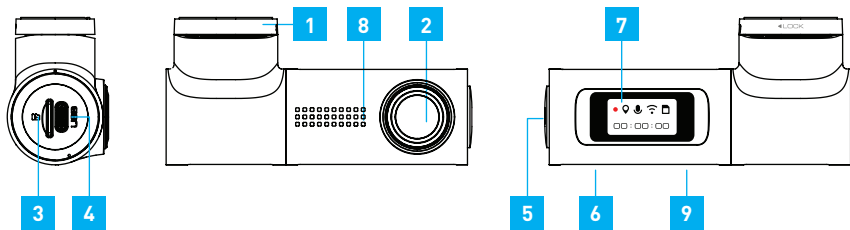

1. 3M adhesive mount
2. Lens
3. Micro SD card slot
4. USB Type-C charging port
5. Wi-Fi button

6. Speaker
7. 0.96" display
8. Microphone
9. Reset button

6.0 DISPLAY SCREEN INDICATORS

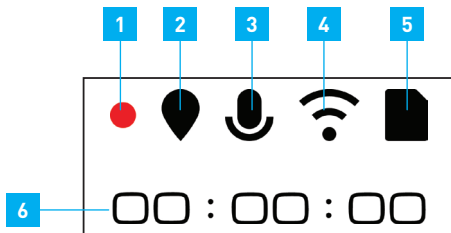

1. Recording Indicator
2. GPS
3. Audio recording
4. Wi-Fi indicator
5. Memory card indicator
6. Time

RECORDING INDICATOR

COLOUR	STATUS
Red blinking	Recording normal video
Yellow blinking	Recording locked video

NOTE:

The clock will be displayed during normal recording while the recording duration of the locked video segment will be displayed during emergency recording.

7.0 QUICK KEY FUNCTIONS

By pressing the Wi-Fi button, you can access several quick key functions:

FUNCTION	OPERATION
Turn on/off Wi-Fi	Short press once
Turn on/off audio	Short press twice
Lock video	Long press (3s)
Format memory card	Long press (8s)

- Formatting the Micro SD card will delete all information on the inserted Micro SD card and prepare the card for use with the dash camera.

8.0 INSTALLATION INSTRUCTIONS

OPTIONAL ELECTROSTATIC FILM MOUNTING

The electrostatic film enables easy removal of the dash camera from the windscreen. Before mounting the electrostatic film, please wipe the windscreen glass clean. Tear off the protective layer of the electrostatic film, adhere it to the windscreen and push out any bubbles between the electrostatic film and the glass.

1. Peel off the protective cover of the 3M adhesive tape on the dash camera mount and position the dash camera in the middle of the electrostatic film (if used) or directly to the windscreen if not. Press down the mount and hold for about 30 seconds to ensure good adhesion. Then adjust the lens of the camera by rotating the barrel to face the road ahead.

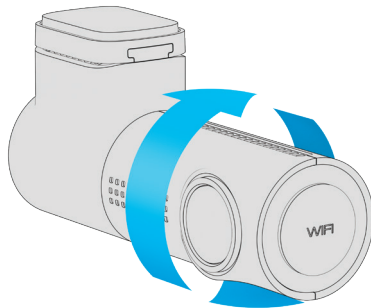

2. Plug the supplied Type-C Charger cable into the dash camera USB port and the other adaptor into the vehicle's 12/24V output port. Run the dash camera cable along the top of the front windshield through the A-pillar and around the storage compartment. Use the supplied pry tool to help tuck in the power cord.
3. To remove the dash camera from the mount, slide the dash camera to the left of the mount as shown below.

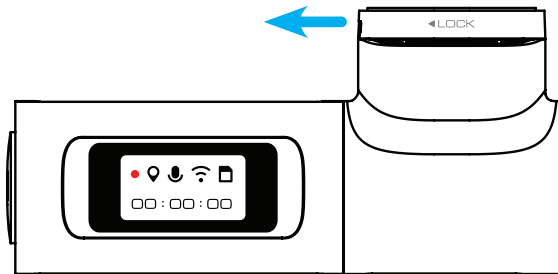

9.0 GETTING STARTED

The dash camera is designed to power up and record automatically when the vehicle ignition is turned on. It will also save the recorded video. The dash camera will turn off automatically when the vehicle ignition is turned off.

AUTO POWER ON/OFF

Plug in the 12/24V adaptor into the vehicle's 12/24V output port. When the vehicle ignition is turned on, the dash camera will power up and start recording automatically. The dash camera will shut down once the vehicle ignition is turned off.

MANUAL POWER ON/OFF

To turn on the dash camera manually, press the dash camera power button once. To switch off the dash camera, press and hold the power button for at least two seconds.

NOTE:

- A Micro SD card (not included) needs to be inserted into the dash camera and formatted for the first time to enable recording.
- Please ensure that the dash camera is constantly powered through the adaptor as the built-in supercapacitor battery is only used to record timings.
- The dash camera will automatically update its time and date when it is connected to its app on a smartphone via Wi-Fi.
- Some vehicles may have a 12/24V output port that is always on. This means that the vehicle battery will provide constant power to the dash camera even when the vehicle ignition is turned off. This will drain the vehicle's battery. To rectify this situation, you can do the following:
 1. Hardwire the dash camera to the vehicle's fuse box with a 3-wire hardwire kit (not included).
 2. Change the connection in the fuse box for the 12/24V output to supply power only when the car ignition is turned on or to the ACC position.

10.0 MICRO SD CARD WARNING

This dash camera can only be used with Micro SD cards, Class 10 or above with storage capacities from 32GB to 128GB maximum. The Micro SD card is not included with your purchase.

NOTE:

Formatting the Micro SD card will delete all information on the inserted Micro SD card and prepare the card for use with the dash camera.

10.1 FORMATTING A MICRO SD CARD

There are two ways to format a Micro SD card

1. Insert the Micro SD card into the dash camera. Press and hold the Wi-Fi button on the dash camera for at least 8 seconds to format the memory card and restore the dash camera to factory settings. When formatting is successful, a message indicating success will appear on the screen.
2. Connect the dash camera to the App with the instructions given in Section 11.0 on page 18. Then enter the Settings section and press 'Format SD card'. The dash camera will provide an audio notification that formatting has been successful.

11.0 DOWNLOADING AND INSTALLING THE NCP-SYNC APP

The dash camera needs to be used in combination with the NCP-SYNC App to function correctly. All the major settings on the dash camera are edited through the App.

Scan the QR code to download the App.



SYSTEM REQUIREMENTS

iPhone	iOS 8.0 and above version
Android	Android 5.0 and above version

1. Download the NCP-SYNC App and install it on your smartphone. You can search for the App on Apple App Store for iOS devices or Google Play Store for Android devices. Alternatively, you can scan the QR code provided to download the App.
2. Once the App is downloaded and installed on your smartphone, power up the dash camera and go to your smartphone Wi-Fi settings to connect your smartphone to the dash camera.

Wi-Fi name	NCP-DVR200_XXXX (where XXXX is a unique number assigned to each dash camera)
Password	12345678

NOTE:

- When your smartphone is connected to the dash camera via Wi-Fi, it will say 'No internet connection' on your smartphone. This is because the dash camera built-in Wi-fi is only used for video/photo transfer and not for broadcast over the internet. Please ignore this prompt.
- To ensure that the DVR pairs with your smartphone properly, please turn on the DVR and keep the smartphone in close proximity to the DVR for successful pairing via Wi-Fi. The DVR will need to be continuously powered on to maintain the connection with your smartphone.

12.0 NCP-SYNC APP OPERATION

DASH CAMERA WI-FI

Instead of Bluetooth, the built-in Wi-Fi feature on the dash camera is designed to pair the dash camera to your smartphone and access recordings instantly from the dash camera. However, the Wi-Fi from the dash camera is not meant for broadcast of your footage over the internet. It only allows your smartphone to receive live and recorded footage on your smartphone within the effective Wi-Fi range of the dash camera.

Similar to how a home Wi-Fi network works, the Wi-Fi signal will only work when your smartphone is within a certain range from the dash camera. The maximum Wi-Fi connection range is 3m between the dash camera and your smartphone.

12.1 VIDEO PLAYBACK

For video playback via the App, please follow the instructions below:

1. Open the NCP-SYNC App.
2. Press the Album button.
3. Click on the Video Folder and select the video that you wish to view.

12.2 VIDEO DOWNLOAD

To download your dash camera videos, please follow the instructions below:

1. Open the NCP-SYNC App.
2. Press the Album button.
3. Select the video(s) and press the download button to start the download.
4. Once the video(s) are downloaded to your smartphone, you can access them via the App in the folder named Local.

12.3 VIDEO SHARING ON SOCIAL MEDIA

To share videos on social media, please follow the instructions below:

1. Open the NCP-SYNC App.
2. Press the Album button.
3. Open the Local folder in the App to access all downloaded videos.
4. Select the video(s) that you wish to share and then press the Share button.
5. Select the social media platform that you wish to share on.

13.0 NCP-SYNC APP SETTINGS

FUNCTION	SETTING	DESCRIPTION
Video Resolution	1920 x 1080 30FPS	Changes the resolution of the recorded video.
Loop Recording	1/2/3 minutes	Sets the duration for the camera to record before creating a new clip.
Audio Recording	On/Off	Turns microphone on/off.
WDR	On/Off	Turns on/off Wide Dynamic Range (WDR). Wide Dynamic Range technology improves a camera's image quality under high-contrast lighting conditions when both dimly and brightly-lit areas are present in the field of view.
G-Sensor	Off/High/Mid/ Low	Monitors your vehicle for impacts. The dash camera will automatically lock the recording in the event of a collision. The sensitivity of the G-sensor can be adjusted.

NCP-SYNC APP SETTINGS CONT'

FUNCTION	SETTING	DESCRIPTION
Parking Monitor*	On/Off	<p>Monitors the vehicle when parked and goes into time lapse recording mode. When your vehicle encounters an impact, the dash camera will start a one-minute recording and saves and locks the video.</p> <p>Default: Off</p> <p><small>* Requires installation of a 3-wire hardwire kit</small></p>
Time-lapse Parking Monitor Duration*	8H/12H/24H/ Always On	<p>Sets the duration of the time lapse recording when the car is in Parking Monitor Mode.</p> <p><small>*Requires installation of a 3-wire hardwire kit</small></p>
Auto LCD OFF	Always On/Off/ After 1min	Turns off default Auto LCD OFF setting.
Volume	Off/Low/Mid/ High	Controls the sound level of the built-in speaker.

NCP-SYNC APP SETTINGS CONT'

FUNCTION	SETTING	DESCRIPTION
Speed Unit	km/h and mph	Selects speed unit for the GPS stamping on the recorded video.
GPS Information		Provides GPS information

VIDEO STAMPS		
Speed	On/Off	Stamps speed of the car on the recorded video
GPS Coordinates	On/Off	Stamps GPS coordinates on the recorded video
Date and Time	On/Off	Stamps date and time on the recorded video

NCP-SYNC APP SETTINGS CONT'

SYSTEM SETTINGS		
Synchronise Time		Synchronises time with your mobile device
Micro SD Card Information	NA	Indicates the free space on the inserted Micro SD card
Wi-Fi	NA	Edits dash camera Wi-Fi name and default password.
Format SD Card	NA	Formats the Micro SD Card and deletes all existing data on the memory card.
Default Settings	NA	Restores factory settings
Firmware version	NA	Firmware version details

14.0 WARRANTY TERMS AND CONDITIONS

Our goods come with guarantees that cannot be excluded under the Australian Consumer Law. You are entitled to a replacement or refund for a major failure and for compensation for any other reasonably foreseeable loss or damage. You are also entitled to have the goods repaired or replaced if the goods fail to be of acceptable quality and the failure does not amount to a major failure.

This warranty is provided in addition to your rights under the Australian Consumer Law. Directed Electronics Australia Pty Ltd (Directed Electronics) warrants that this product is free from defects in material and workmanship for a period of 12 months from the date of purchase or for the period stated on the packaging. This warranty is only valid where you have used the product in accordance with any recommendations or instructions provided by Directed Electronics.

This warranty excludes defects resulting from alterations of the product, accident, misuse, abuse or neglect. In order to claim the warranty, you must return the product to the retailer from which it was purchased or if that retailer is part of a national network, a store within that chain, along with satisfactory proof of purchase. The retailer will then return the goods to Directed Electronics.

Directed Electronics will repair, replace or refurbish the product at its discretion. The retailer will contact you when the product is ready for collection. All costs involved in claiming this warranty, including the cost of the retailer sending the product to Directed Electronics, will be borne by you.

Email: info@nanocamplus.com.au

Ph: +61 03 8331 4800

INDEMNITY

You agree to defend, indemnify and hold harmless Nanocam Plus and its subsidiaries and affiliates from and against any and all claims, proceedings, injuries, liabilities, losses, costs and expenses (including reasonable legal fees), including but not limited to, claims alleging negligence, invasion of privacy, copyright infringement and/or trademark infringement against Nanocam Plus and its subsidiaries and affiliates, relating to or arising out of your breach of any provision of these terms, your misuse of Nanocam Plus products or its services, or your unauthorised modification or alteration of products or software.

WARRANTY AND WARRANTY DISCLAIMER

Nanocam Plus has a limited warranty on whereby Nanocam Plus warrants to you and only to you that this Nanocam Plus product will be free from defects in materials and workmanship for one (1) year from the date of your purchase (unless a longer warranty period is required by law). The specifics of this Nanocam Plus limited warranty are covered in this manual. To the extent possible under governing law, other than the above product warranty for the Nanocam Plus product, you understand and agree that the Nanocam Plus products and services are provided on an "as is" and "as available" basis. Nanocam Plus makes no warranty that the Nanocam Plus products and services will meet your requirements or that use of the Nanocam Plus products and services will be uninterrupted, timely, secure or error-free nor does Nanocam Plus make any warranty as to the accuracy or reliability of any information obtained through Nanocam Plus (including third party content), that any defects in Nanocam Plus products and services will be corrected or that Nanocam Plus products or services will be compatible with any other specific hardware or service. Further, Nanocam Plus does not warrant that Nanocam Plus products or services or Nanocam Plus servers will provide you with data and content are free of viruses or other harmful components. Nanocam Plus also assumes no responsibility for and shall not be liable for any damages caused by viruses that may infect your Nanocam Plus product or software. In the event of any loss, damage or injury, you will not look to Nanocam Plus to compensate you or anyone else. You release and waive for yourself and your insurer all subrogation and other rights to recover against Nanocam Plus arising as a result of the payment of any claim for loss, damage or injury. Nanocam Plus equipment and services do not cause and cannot eliminate occurrences of

certain events and Nanocam Plus makes no guarantee or warranty, including any implied warranty of merchantability or fitness for a particular purpose or that Nanocam Plus equipment and services provided will detect or avert such incidents or their consequences. Nanocam Plus does not undertake any risk that you or property, or the person or property of others, may be subject to injury or loss if such an event occurs. The allocation of such risks remains with you, not Nanocam Plus. Other than the above product warranty for Nanocam Plus products, its suppliers disclaim all warranties of any kind, whether express, implied, or statutory, regarding Nanocam Plus products and services, including any implied warranty of title, merchantability, fitness for a particular purpose, or non-infringement of third party rights. Because some jurisdictions do not permit the exclusion of implied warranties, the last sentence of this section may not apply to you. Nanocam Plus hereby further expressly disclaims all liability for claims for service failures that are due to normal product wear, product misuse, abuse, product modification, improper product selection or you noncompliance with all applicable federal, state or local laws.

This warranty and warranty disclaimer give you specific legal rights, and you may have other rights that vary by state, province or country. Other than as permitted by law, Nanocam Plus does not exclude, limit or suspend other rights you have, including those that may arise from the non-conformity of a sales contract. For a full understanding of your rights, you should consult the laws of your state, province, or country. For our Australian customers: please note that this warranty is in addition to any statutory rights in Australia in relation to your goods which, pursuant to the Australian Consumer Law, cannot be excluded.

LIMITATIONS OF NANOCAM PLUS LIABILITY

Under no circumstances will Nanocam Plus be liable in any way for any content, including, but not limited to, the loss of content, any errors or omissions in any content, or any loss or damage of any kind incurred in connection with use of or exposure to any content posted, emailed, accessed, transmitted, or otherwise made available via Nanocam Plus. Nanocam Plus liability for damages, especially for breach of duty or obligation, delay in performance, non-performance, or malperformance shall be precluded, except when these are due to negligent breaches of any significant contractual duty or obligation on the part of Nanocam Plus. Any liability for negligence is limited to direct losses usually and typically foreseeable in such case. Should the claim for damages be based on wilful or grossly negligent breach of contractual duty or obligation on the part of Nanocam Plus, the preclusion and limitation of liability mentioned in the preceding sentences will not apply. The preceding preclusion and limitation of liability will also not apply to claims for damages arising out of loss of life, bodily injury or health impacts for which Nanocam Plus may be liable, or for non-contractual liability.

Some states and countries do not allow the exclusion or limitation of incidental or consequential damages, so the above limitation or exclusion may not apply to you. Additionally, this provision is not intended to limit Nanocam Plus' liability in the event of Nanocam Plus' wilful or intentional misconduct.

Your Safety. Our Priority.

www.nanocamplus.com.au | www.nanocamplus.co.nz



All Images, Information and Content are Copyright © 2023
Directed Electronics Australia Pty Ltd. All Rights Reserved.

DIRECTED
AUSTRALIA & NZ

www.directed.com.au
www.directed.co.nz